



CASE STUDY: EXTENSION AND ALTERATIONS TO NEW BUILD HOME



OVERVIEW:

The property is a modern 5 bedroom detached house in the market town of Shipston on Stour, Warwickshire.

CHALLENGE:

Whilst the ground floor layout offered adequate reception space, the existing dining room was small and not connected to the kitchen. So the clients decided to extend the home to create a sociable space to entertain friends and family.

SOLUTION:

The design provides a side extension with a dining room and snug area connected to the kitchen, and the existing dining room has become a separate study.

The rear wall of the new dining space is angled to draw the eye onto the best views over the countryside, and light floods the space through bi-fold doors and a ceiling roof lantern in the dining area.

RESULT:

The design fulfils the client's brief for modern day family living with an open plan kitchen/dining space. The angled wall successfully creates a dynamic space and effectively directs the view over the surrounding fields and open countryside.

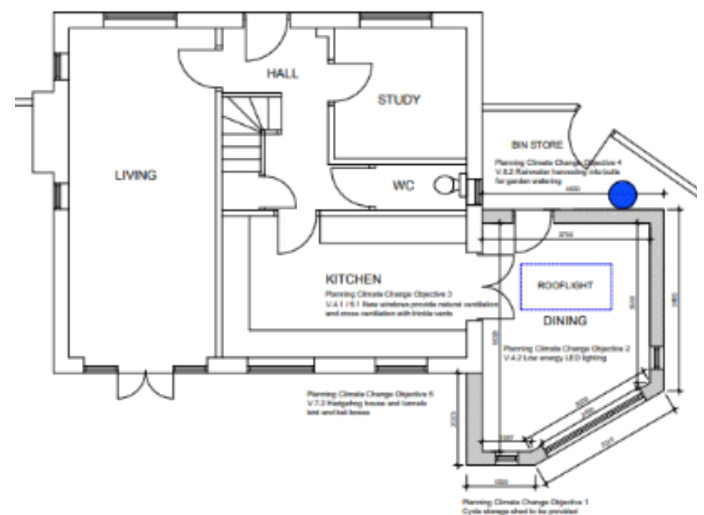

PROJECT BENEFITS:

- Open plan kitchen dining space for entertaining family and friends
- Cosy snug area
- Views over open countryside
- Self contained study

“Hi Emma, finished 4 weeks ago - build, new kitchen and new flooring fitted from front door to bifolds in 4 months. We are very happy with the results - just need to furnish it now! Photos probably don't fully reflect how good it looks. Thanks again for all your help.”